

- High temperature range up to +250 °C
- 10m FEP-cable
- M12-Plug connection to amplifier

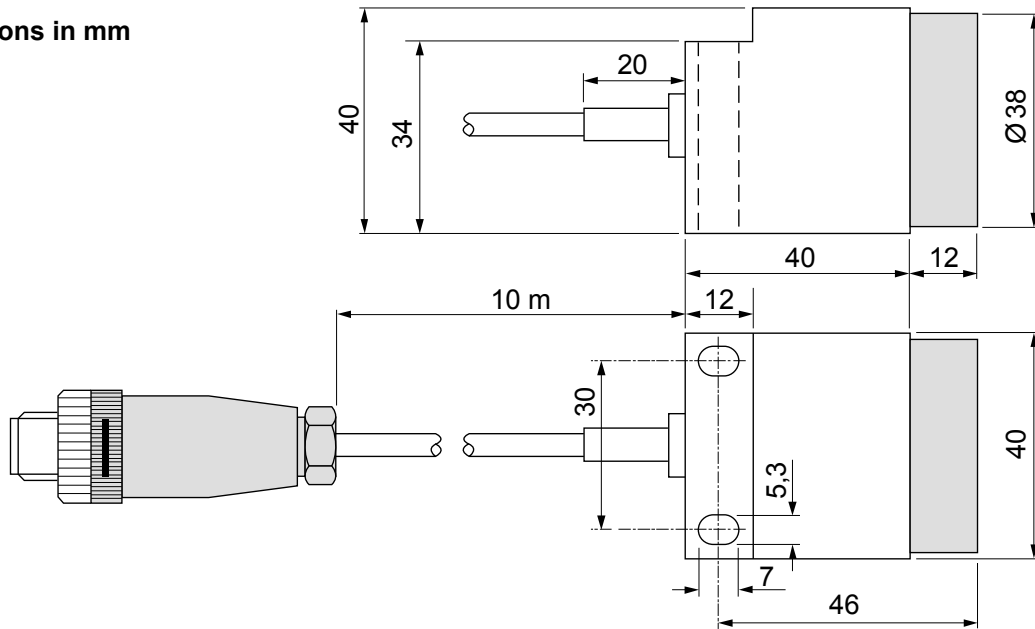

**Dimensions in mm**



**Technical data**

Switching distance $S_n$	: 20 mm non-flush
Operating distance	: 0,8 $s_n$
Hysteresis	: <0,1 $s_n$
Temperature range sensor	: 0 °C...+250 °C
Temperature male connector	: -20 °C...+70 °C
Protection class to EN 60529	: IP 60
Housing	: Aluminium, PEEK
Cable	: 10m FEP-cable
Connection	: M12 Plug-in-system

**Connection**

External view  
M12 Plug-in-system

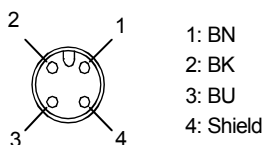

Colour code: BN: brown BK: black BU: blue

